

Cladding Profile

Metalbenz Interlocking Panel



Use this profile with a wide range of metals

Metalbenz fabricates a panel with a tongue and groove pattern, known as an 'interlocking panel'. The right groove of the panel is secured to the wall or support with screws or expansion clips (for longer lengths), and the left tongue of the next panel slides into the groove of the first panel, concealing the fixing and providing a seamless façade.

Factors

Panel Width: 200 mm – 300 mm (custom sizes available on request).

Panel Height: 25 mm.

Panel Length: Max. recommended length horizontal 4 m.
Max. recommended length vertical 3 m
(longer lengths available on request).

Shadow gaps: 1 mm – 25 mm.

Substrate: 20 mm – 40 mm battens (typically metal battens) over breather type sarking.

Underlayer: A ventilated airspace behind panels is recommended and is a requirement for titanium zinc installation.

Variations: Horizontal, vertical/tapered 2 edged grooves, 2 edges (start and end panels) can be installed on curved structures eg vertical on a horizontally curving structure.

Roofing: Please contact us for custom solutions.

Benefits: Interlocking panels can be used for a full waterproof screen or curtain wall system.

Precise and uniform sizing with 0.5 mm tolerances can be achieved with use of high quality roll forming machines. Custom made to suit varying and individual measurements on each project.

Light weight. Architectural, modern and suitable for large applications for wall, soffits, ceilings, gates, garage doors.

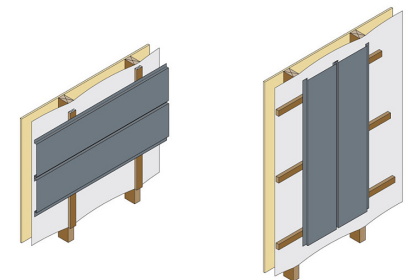
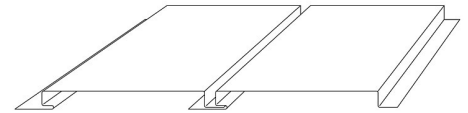

Metal benz
FABRICATION

www.metalbenz.com.au

Visit our website to see our full range of profiles for roofing and wall cladding. We also custom fabricate flashings, rainwater systems and supply pre-fabricated systems.

Phone: 02 9986 0891